

Project name: \_\_\_\_\_

Norm  EN81-70  EN81-70 Annex G (Big buttons)  
 EN81-73  EN81-20/50  
 EN81-28

Modernization

New installation

PD No.: \_\_\_\_\_

Delivery Date: \_\_\_\_\_

Material ordered:

Send us the form via e-mail by clicking here.

## Send e-mail to P DAHL

You can also save the form and send it to us in an e-mail to [order@pdahl.se](mailto:order@pdahl.se)



Company name: \_\_\_\_\_

Contact name: \_\_\_\_\_

Telephone no.: \_\_\_\_\_

E-mail contact \_\_\_\_\_

E-mail document \_\_\_\_\_

Requested delivery date: \_\_\_\_\_

Drawing only

Price request

Order

Delivery address

\_\_\_\_\_

\_\_\_\_\_

\_\_\_\_\_

Other information

Materials not included in the specification.

Note  Default value is marked with a marked corner  
★ New options in version

Please make your selection with a cross

MKT1019-F5

**System**  CAN-BUS  Conventional wiring

## Machinery

Rope  Hydraulic  Chain

Rope-Drum  Hydraulic 2:1  Screw

MRL

Painted  Stainless Cabinet

2 x 0,4 x 0,2 (m)  2 x 0,5 x 0,3 (m)

Incoming cables  Top  Bottom

At cabinet 2 x 0,5 x 0,5 frequency inverter can be placed in i cabinet  
At cabinet 2 x 0,4 x 0,2 an extra cabinet is required for frequency inverter

Load: \_\_\_\_\_ / \_\_\_\_\_ kg/people

No. of floors: \_\_\_\_\_ Speed: \_\_\_\_\_ mps

Numbers of lifts in group: \_\_\_\_\_

Numbers of calls per floor: \_\_\_\_\_

Push Button  Down Coll.  Down-/Up Collective

Main Power  3x230 VAC  3x400 VAC  3x500 VAC

Connection  TN-S  TN-C  TT  IT

Safety Circuit  48 VAC  110 VAC  230 VAC

Cabinet Door  Left  Right

Outlet  Bristle IP21  Glands IP54

## Motor Control

Hydraulic lift

Star/Delta

SoftStart

No  Yes Cabinet

6 Wires

3 Wires

Direct

6 Wires

3 Wires

Rope lift

1-Speed

2-Speed

VVVF

Open Loop (without encoder)

Close Loop (with encoder)

PM (gearless)

For 2-speed lifts please state high/low  
For lifts with sliding contacts state the secondary in notes

## Motor Data

\_\_\_\_\_ (kW) Manufacturer: \_\_\_\_\_

\_\_\_\_\_ In (A)

\_\_\_\_\_ (V)

\_\_\_\_\_ (RPM)

\_\_\_\_\_ (Hz)

Valves  AC  DC \_\_\_\_\_ V \_\_\_\_\_ A

Motor fan  No  Yes \_\_\_\_\_ V \_\_\_\_\_ A

No  Yes Pawl

AC  DC \_\_\_\_\_ V \_\_\_\_\_ A

No  Yes Brake (prim) \_\_\_\_\_ / \_\_\_\_\_ V/V \_\_\_\_\_ / \_\_\_\_\_ A/A

No  Yes Brake 2 (sec)\* \_\_\_\_\_ / \_\_\_\_\_ V/V \_\_\_\_\_ / \_\_\_\_\_ A/A

\* Break 2 is the emergency break for the gear.

No  Yes Mechanical brake release

No  Yes SG-Lock \_\_\_\_\_ V \_\_\_\_\_ A

No  Yes SG UPS

No  Yes SG Reset \_\_\_\_\_ V

No  Yes SG Release \_\_\_\_\_ V

No  Yes Main Limit Switch 3-phase

No  Yes Main Power Switch

On door  Separately  Cabinet

No  Yes Marking of Cables If special demands, please note the specification

Null-Null  Connection Marking

Other \_\_\_\_\_

No  Yes Halogenfree cables/Cableducts

No  Yes Relevelling

No  Yes Floor zone indicator

No  Yes Indicator flooding device

No  Yes Switch for shaft light in cabinet

No  Yes Fulload

Yes Overload function (indicate the unit location)

Car  Cabinet  Existing / Prepared

No  Yes Cabinet light (LED)

No  Yes Car Light Control

No  Yes Residual-current device for light

No  Yes Telecom surge protector

No  Yes Voltage surge arrester

No  Yes Parking floor: \_\_\_\_\_

No  Yes Fireservice, please note floors: \_\_\_\_\_

No  Yes On-hold driving from main limit switches

In cabinet  In separate box, incl 10m

No  Yes Code Lock

Car button, state floor \_\_\_\_\_

Call button, state floor \_\_\_\_\_

No  Yes Priority Calls

Car

Floors, please note floors: \_\_\_\_\_

No  Yes Small Headroom and Pit

Pit

Electrical support

Manual support

Headroom

Barrier under CW

Barrier on car roof

Shaft door surveillance

Emergency door key

Hidden/extra door contact

MKT1019-F5

No  Yes Floor Indicator

- In Car
- At floor, specify placement in table
  - Arrival Signal

No  Yes Current/Other supplier

- Floor indicator
- Arrival signal
- Directional arrows
- Lamps/Diodes < 4W/plan
- Lamps > 4W
- Digital, specify: \_\_\_\_\_

**Info:** PDAHL floor indicators show. Overload, Fire alarm, Arrows, Floor, Service, Lift Off, Arrival signal.

Explanation current signaling

\_\_\_\_\_

\_\_\_\_\_

\_\_\_\_\_

## Car door/light curtain with swingdoor

No  Yes Swingdoor, state placement of doors in shaft

- No  Yes Retiring Cam
  - AC  DC \_\_\_\_\_ V
- No  Yes Door operator on door
  - 1-Phase  3-Phase  VVVF, type: \_\_\_\_\_
- No  Yes Door operator on car
  - 1-Phase  3-Phase  VVVF, type: \_\_\_\_\_
- No  Yes Extra door contact (hidden)
- No  Yes Early dooropening

No  Yes Wicked car door/gate

- 3-Phase  VVVF, type: \_\_\_\_\_
- Manual operated and manually operated door locks
  - No  Yes 48 V Safety Circuit
- No  Yes Early dooropening

No  Yes Photo cell curtain (override at arrival at floor)

Type: \_\_\_\_\_

Manufacturer: \_\_\_\_\_

## Automatic door

No  Yes Automatic door, state placement in shaft table

- 3-Phase  VVVF, type: \_\_\_\_\_
- Manufacturer: \_\_\_\_\_
- No  Yes Early door opening

# Specification - Material included in the delivery from PDAHL

No  Yes Cabinet Stand

No  Yes Standby unit LA5

No  Yes Telephone

Line       GSM

SafeLine SL6

Other, specify: \_\_\_\_\_

No  Yes Intercom for communication between control cabinet and:

Car roof       Pit

No  Yes Camera surveillance of car or shaft

No  Yes Junction box car top  Grey       Black

Bristle (IP21)       Glands (IP54)

No  Yes Positioning

Photocell

Incremental (required with low pit/overhead)

Cartop       Counterweight       Roundabout

        Beltlength: \_\_\_\_\_ m

Encoder on speed governor

No  Yes Separate sync magnet

No  Yes Magnetic switches upper/lower limit \* (mechanical switch with control limit)

Magnets wall mounted

Magnets on mounting kit on guide

No  Yes Encoder motor, 10-30V, 1024 pulses / revolution

No  Yes Motor axle, specify size: \_\_\_\_\_

No  Yes Photocell Curtain

No  Yes Supervised       Model A       Model J

No  Yes Not supervised       Model A       Model B

No  Yes 3D

No  Yes Shaft light, supply full shaft height: \_\_\_\_\_ m (Plug-in, incl. armature, flourescent lamp, outlet in pit, cordlightning)

No  Yes UPS

Release brake       Evacuate to floor

UPS Surveillance

Mounting rack

No  Yes Overload unit

Rope      \_\_\_\_\_ Nbr of ropes      \_\_\_\_\_ Diameter

Car      \_\_\_\_\_ Nbr of sensors

Beam       1pcs sensor       2pcs sensors

No  Yes Emergency stop for pit incl. 2m cable \_\_\_\_\_ pcs.

No  Yes Emergency stop for machine room incl. 5m cable \_\_\_\_\_ pcs.

No  Yes Alarm push button under car incl. 5m cable \_\_\_\_\_ pcs.

Under car       Pit (cables in shaft harness)

No  Yes Flooding device incl. 5m cable (cables in shaft harness)

No  Yes Maintenance running control for machine room \_\_\_\_\_ m

No  Yes Controls for pulleyroom incl. 10m cable

No  Yes Operating panels, supply drawings

No  Yes Installation ducts for machinerroom \_\_\_\_\_ pcs.

No  Yes Cable protection for car roof \_\_\_\_\_ pcs.

No  Yes Fixing kit (screws, straps, etc)

No  Yes Emergency light 12V recessed in car roof \_\_\_\_\_ pcs.

No  Yes Separate supply for power off indicators on LOP

No  Yes Speed Governor       Existing

No  Yes EN 81-1 A3      200mm      250mm      300mm

No  Yes Tension pulley       Pit       Guide rail

No  Yes HR-stands, break in/out rope 150-330mm

No  Yes Remaining installation cable (locks, doors, push buttons)

No  Yes Travelling cable      Length: \_\_\_\_\_ m

Flat       Round

    Cable Fixings      Car: \_\_\_\_\_ pcs      Shaft: \_\_\_\_\_ pcs

Prewired for cartop box       Prewired cabinet

No  Yes \_\_\_\_\_ :Reserv parts with marked terminals

No  Yes Motor cable lengt: \_\_\_\_\_ m

No  Yes Power supply cable lengt: \_\_\_\_\_ m

Machine Room       Up       Down

Cable length cabinet to first junction      \_\_\_\_\_ mm

	Side A		Side B		Headroom
	Floorindicator designation	A/S/M/V	A/S/M/V	Floorindicator designation	
16					_____ mm
15					_____ mm
14					_____ mm
13					_____ mm
12					_____ mm
11					_____ mm
10					_____ mm
9					_____ mm
8					_____ mm
7					_____ mm
6					_____ mm
5					_____ mm
4					_____ mm
3					_____ mm
2					_____ mm
1					_____ mm

Headroom

Landing distance

15-16 \_\_\_\_\_ mm

14-15 \_\_\_\_\_ mm

13-14 \_\_\_\_\_ mm

12-13 \_\_\_\_\_ mm

11-12 \_\_\_\_\_ mm

10-11 \_\_\_\_\_ mm

9-10 \_\_\_\_\_ mm

8-9 \_\_\_\_\_ mm

7-8 \_\_\_\_\_ mm

6-7 \_\_\_\_\_ mm

5-6 \_\_\_\_\_ mm

4-5 \_\_\_\_\_ mm

3-4 \_\_\_\_\_ mm

2-3 \_\_\_\_\_ mm

1-2 \_\_\_\_\_ mm

Pit depth \_\_\_\_\_ mm

Info

A = Automatic | M = Machine room | S = Swingdoor | V = Floor Indicator

No  Yes Duct (50x50, knockout)       Grey       Black

No  Yes Shaft installation cable

Non Jacketed       Jacketed

Loose cable       Prewired

Terminals in duct       Terminals in a junction box

Plate       IP54

No  Yes Plugin for signalisation

MKT1019-F5

- No  Yes Motor
  - Gearless (PM)
  - Gear (incl. oil)
  - Gear EN81-1 A3 (with SSB brake) (incl. oil)
  - Drum, gear (incl. oil)
  - Drum, gear EN81-1 A3 (with SSB brake) (incl. oil)
  - Encoder cable, length \_\_\_\_\_ m
- No  Yes Rope clamps (2st)
- No  Yes Machine bed fram (Incl. potential diverting pulley)
- No  Yes Pulley (SKF bearings)
  - Diameter (pulley) \_\_\_\_\_ mm
  - Diameter (rope) \_\_\_\_\_ mm
  - Grooves \_\_\_\_\_ pcs
  - Pitch \_\_\_\_\_ mm
  - Axle length \_\_\_\_\_ mm
- No  Yes Bearing brackets (2pcs)

- No  Yes Main ropes
  - Diameter \_\_\_\_\_ mm
  - Ropes \_\_\_\_\_ pcs
  - Length \_\_\_\_\_ m
  - Braking force \_\_\_\_\_ kN
- No  Yes SG-rope (speed governor)
  - Diameter \_\_\_\_\_ mm
  - Length \_\_\_\_\_ m
- No  Yes
  - Amount \_\_\_\_\_ pcs
- No  Yes Wire locks for main rope
  - Amount \_\_\_\_\_ pcs
- No  Yes Wire locks for SG
  - Amount \_\_\_\_\_ pcs
- No  Yes Wire tejp (50mm x 5m)
- No  Yes Wedge type socket
  - Rope diameter \_\_\_\_\_ mm
  - Amount \_\_\_\_\_ pcs

## Information about current system

Simple wrap

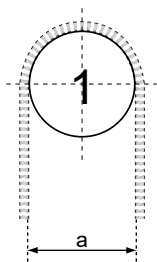

a= \_\_\_\_\_ mm  
Diameter sheave 1 \_\_\_\_\_ mm

Simple wrap with diverting pulley

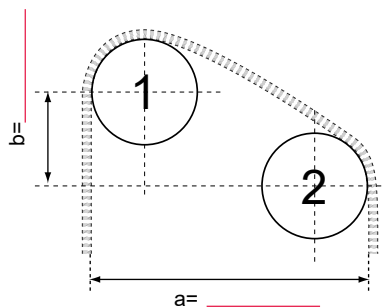

a= \_\_\_\_\_ mm  
Diameter sheave 1 \_\_\_\_\_ mm  
Diameter sheave 2 \_\_\_\_\_ mm

Double wrap with diverting pulley

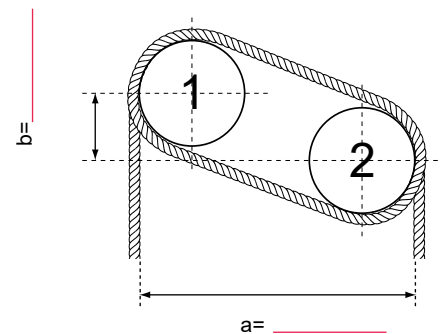

a= \_\_\_\_\_ mm  
Diameter sheave 1 \_\_\_\_\_ mm  
Diameter sheave 2 \_\_\_\_\_ mm

## Information about becoming system

Motor placement  Machine room  Headroom

Suspension

- 1:1
- 2:1
  - Pulleys car side \_\_\_\_\_ pcs
  - Pulleys counterweight side \_\_\_\_\_ pcs

Car measurements LxWxD \_\_\_\_\_ mm

Car weight, frame incl. frame \_\_\_\_\_ kg

Counterweight (weighted) \_\_\_\_\_ kg

Counterweight measurements

H \_\_\_\_\_ mm x W \_\_\_\_\_ mm x D \_\_\_\_\_ mm

\_\_\_\_\_ kg

Simple sketch of existing placement with critical measurements. If possible, attach photos from machine room and motor.

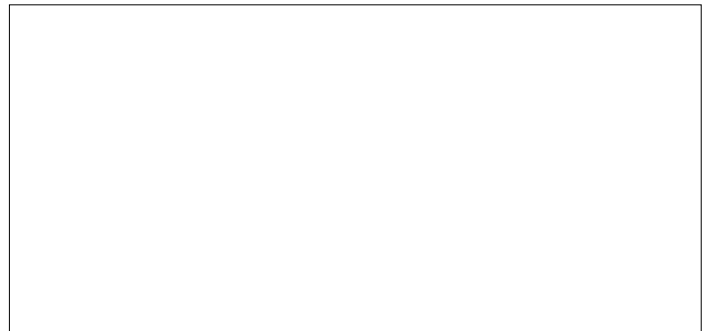

Pitch: \_\_\_\_\_ mm

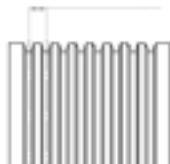

MKT1019-F5

## Material

- Aluminium
- Stainless steel
- Brushed     Polished
- Mässing
- Brushed     Polished
- Not painted     Painted

## Engraving

- Black     White

## Fitting hole/Screw

- 4.5/MFS M4     5/MCS M4     5.5/MFS M5
- 6/MCS M5     7/Kone Shield
- No     Yes Screw provided by PD ( torx )

## Cabling

- No     Yes Halogen free cable
- No     Yes Prewired car panel / floor indicator in car
- 5m cable     State length: \_\_\_\_\_ m
- No     Yes Prewired floor panel / floor indicators at floor
- 2m cable     State length: \_\_\_\_\_ m

## Button type car

- Dual Light (tactile)     B7 Maxi (Annex G)     Panzer <sup>\*IP54/V2</sup>
- No     Yes Braille
- Button     Red     Blue     White
- PDAHL specifies  PB04     PB05     PB06-C     PB06-D

## Button type floor

- Dual Light (tactile)     B7 Maxi (Annex G)     Panzer <sup>\*IP54/V2</sup>
- Button     Red     Blue     White
- PDAHL specifies  Konv.     PB05     PB06-C     PB06-D

## Floor indicator in car

- DF12     TFT/LCD 7"
- LED     Red     Blue     White

## Floor indicator at floor

- DF12     DF31     TFT/LCD 4,3"
- LED     Red     Blue     White

## Loading text / Logo

- No     Yes \_\_\_\_\_ / \_\_\_\_\_ kg/people
- \_\_\_\_\_ language
- Car     Floor
- No     Yes Telephone
- SafeLine SL6
- Linje     GSM
- Incl. telephone     Only prepared
- Other, state type \_\_\_\_\_

## Car Panel

No. of panels \_\_\_\_\_ pcs.

- No     Yes Stop button
- No     Yes Emergency signal
- No     Yes Door opener
- No     Yes Door closer
- No     Yes Overload
- No     Yes Buzzer
- No     Yes Floor indicator
- No     Yes Speech processor

- No     Yes Key switch \*
- Mono-stable
- Bi-stable

\* Specify level and function in "Additional information" below

## Floor Panel

No. of panels \_\_\_\_\_ pcs.

- No     Yes Call button
- No     Yes Up/down button
- No     Yes Up button (not top floor)
- No     Yes Down button (not bottom)
- No     Yes OFF
- No     Yes No entry 
- No     Yes Floor indicator
- No     Yes Arrival signal
- No     Yes Door button
- No     Yes Fire symbol EN81-73

- Engraving
- Sticker
- No     Yes Key switch \*
- Mono-stable
- Bi-stable

- No     Yes Reset low pit/top
- Magnetic switch
- Key switch
- In LOP on floor: \_\_\_\_\_

## Floor Indicator in Car

No. of panels \_\_\_\_\_ pcs.

- No     Yes Speech processor

## Floor Indicator at Floor

No. of panels \_\_\_\_\_ pcs.

- No     Yes Arrival signal

## Montering

Frame / Desk \*\*

- No     Yes Car panel
- No     Yes Floor
- No     Yes Floor indicator in car
- No     Yes Floor indicator at floor

Housing (default depth 50 mm)

- No     Yes Car panel
- No     Yes Floor
- No     Yes Floor indicator in car
- No     Yes Floor indicator at floor

Material frame / desk

- PDAHL-design plastic 23mm (not available for car panel)
- Black     White
- Stainless
- Wood, state material \_\_\_\_\_

\*\* Configuration of the panel affect the depth of frames and desk

## Floor designation (mark entrance floor)

## Address on car panel

## Additional information

---



---



---



---



---

MKT1019-F5

## CAR PANEL

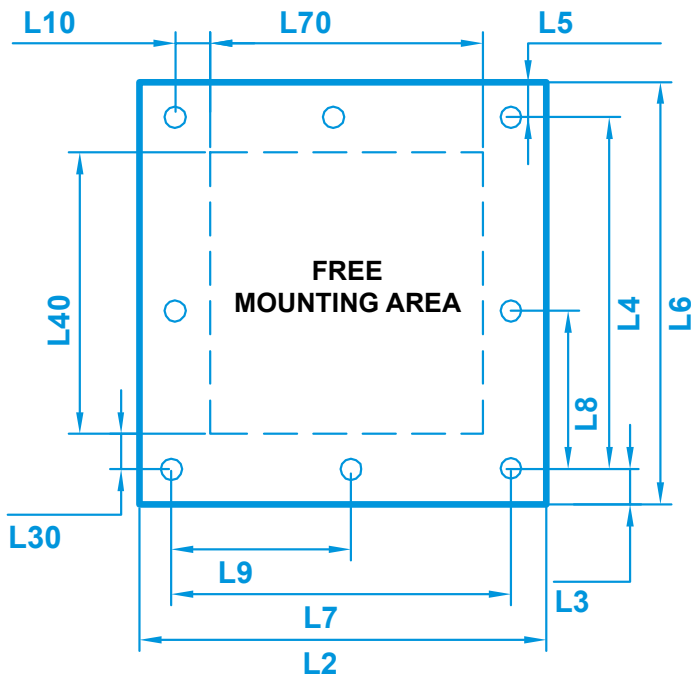

OTHER INFORMATION:

## FLOOR PANEL

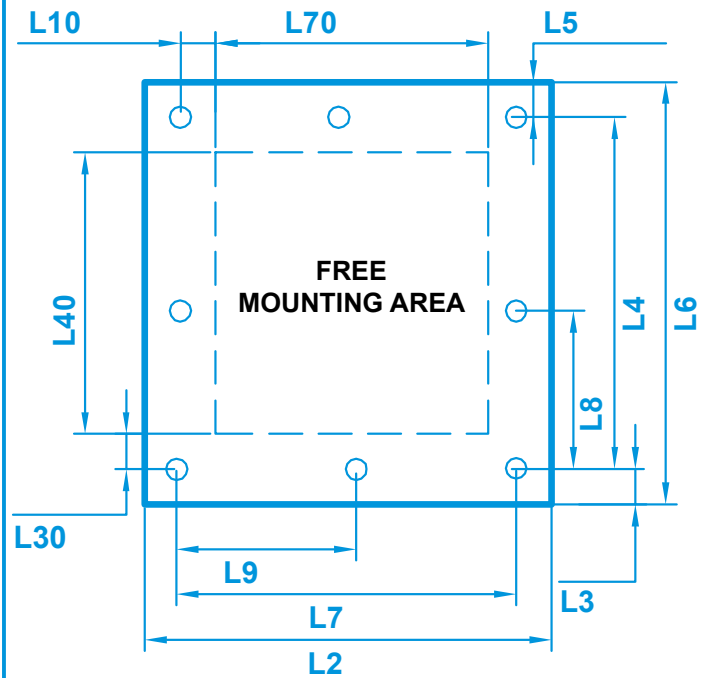

OTHER INFORMATION:

## FLOOR INDICATOR FLOOR

No. of Holes

2 Hole

4 Hole

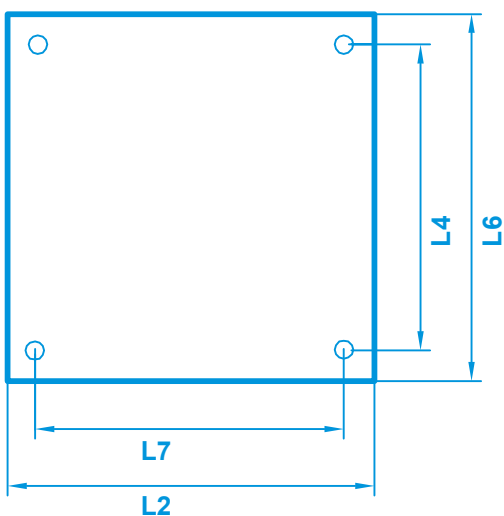

OTHER INFORMATION:

## FLOOR INDICATOR CAR

No. of Holes

2 Hole

4 Hole

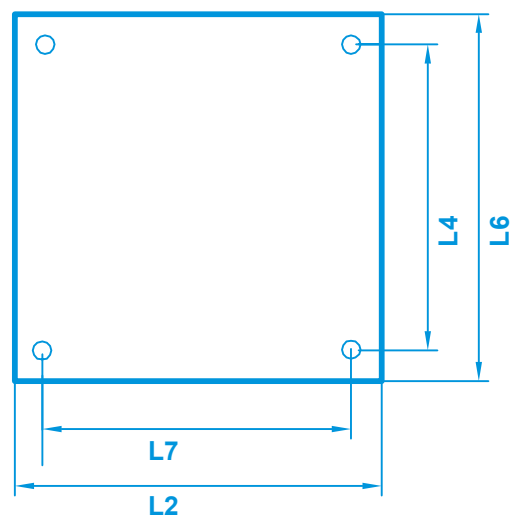

OTHER INFORMATION: